

10 PRINCE STREET, ALEXANDRIA, VIRGINIA 22313

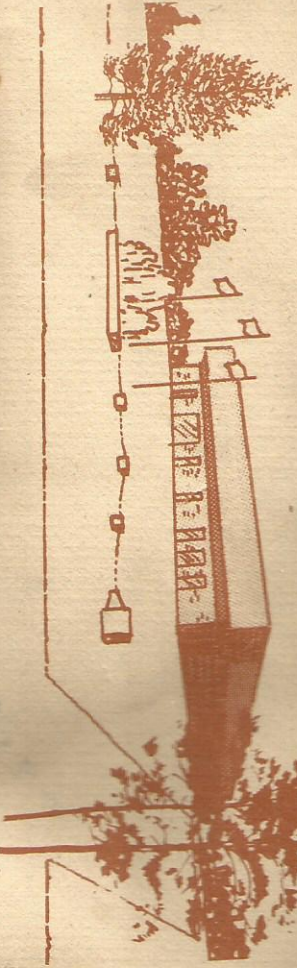

The VIRGINIAN
DRAGOON

From the world's newest and most modern firearms plant located in central Virginia, where fine craftsmanship is a way of life, comes the VIRGINIAN DRAGOON, a single action revolver of a time proven design.



2

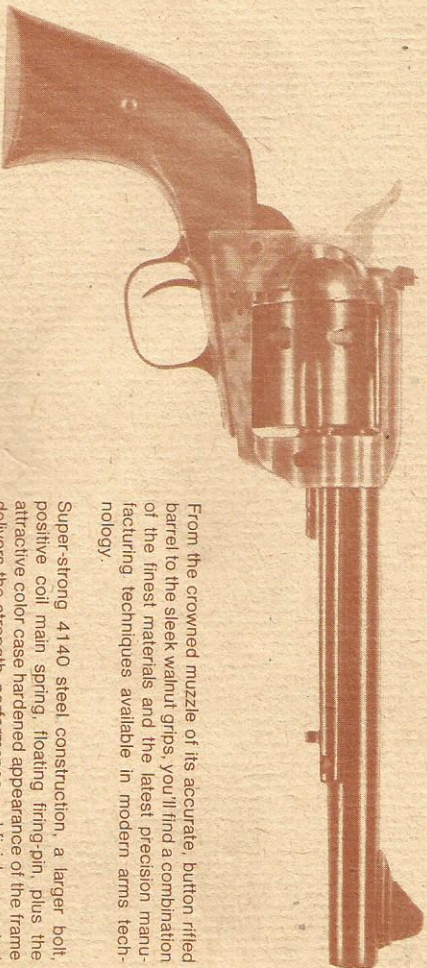

The VIRGINIAN DRAGOON was developed and engineered specifically for the powerful .44 Magnum cartridge (or the popular .45 Colt and .357 Magnum at your option). It is not merely an old design chambered for a larger caliber.

From the crowned muzzle of its accurate, button rifled barrel to the sleek walnut grips, you'll find a combination of the finest materials and the latest precision manufacturing techniques available in modern arms technology.

Super-strong 4140 steel construction, a larger bolt, positive coil main spring, floating firing pin, plus the attractive color case hardened appearance of the frame delivers the strength, performance and finish expected from superior handguns.

The outstanding features of this modern classic are outlined in the following pages . . . and we begin a new chapter in the history of great American-made arms.

With justifiable pride of workmanship, we present the all new Interarms VIRGINIAN DRAGOON.

3

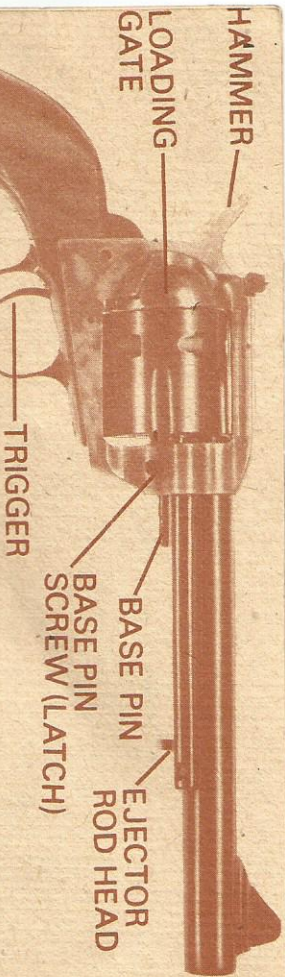

The VIRGINIAN DRAGOON is a single-action revolver. All single-action revolvers require manual cocking of the hammer prior to each shot. As the hammer is drawn to the rear, the cylinder rotates bringing each chamber in line with the barrel. A squeeze on the trigger will then cause the hammer to fall on the spring-loaded, floating firing-pin to fire the cartridge. Recocking the hammer will advance the cylinder and bring the next chamber and cartridge into firing position.

Handgun Safety

The Interarms' VIRGINIAN DRAGOON is provided with a patented-base pin hammer safety (SWISSAFE) which, when properly applied, prevents the hammer from striking the firing-pin when the hammer is in "loading" or "full cock" position. Operation of the "SWISSAFE" is described on page 7.

When you first handle the revolver, without touching the trigger, open the loading gate and inspect the cylinder to be sure it does not contain any cartridges. Always unload the revolver after use or before handing it to another person.

No single-action revolver, the VIRGINIAN DRAGOON or any other make, was built for "tamming" and any attempt to utilize it in this manner may damage the mechanism and make the revolver unsafe. In addition, it will void your factory warranty.

Adequate eye and ear protection devices are recommended for the shooter, as well as others in the immediate vicinity, when discharging any firearm.

Loading & Unloading

To load the VIRGINIAN DRAGOON set the hammer in the loading position, then engage the base pin safety and open the loading gate. Insert a cartridge in each chamber until the cylinder is filled. Close the loading gate prior to firing.

To unload, place the hammer in loading (half-cock) position, open the loading gate and manually rotate the cylinder to align each chamber with the ejector rod, push the ejector rod rearward to eject the case through the gate opening.

One cylinder chamber has a visible dot on each side so that when it is aligned with the bore a dot appears on each side of the frame. This added safety feature is provided as a guide when loading. ALWAYS LEAVE THIS CHAMBER EMPTY AND UNDER THE HAMMER WHEN CARRYING THE GUN LOADED.

ALWAYS OBSERVE ALL RULES FOR FIREARMS SAFETY!

Care and Cleaning

Your precision built VIRGINIAN DRAGOON comes to you factory packaged and preserved. All packing grease and oils should be cleaned from the bore, cylinder chambers, and exposed firing mechanism.

In order to thoroughly clean the VIRGINIAN DRAGOON, the cylinder should be removed. This can be easily accomplished by placing the hammer at the loading (half-cock) position, opening the loading gate, depressing the base pin latch screw and pulling the base pin forward. This will free the cylinder so that it can be removed from the gate side of the frame. Assembly is accomplished by reversing the above procedure.

To keep the VIRGINIAN DRAGOON in perfect operating condition: * Clean barrel bore and cylinder chambers with a bore brush and powder solvent. * Follow by using patches until the patches appear clean. * Wipe the bore, chambers and all external surfaces with a quality gun oil. * All cylinder chambers must be free of oil before firing.

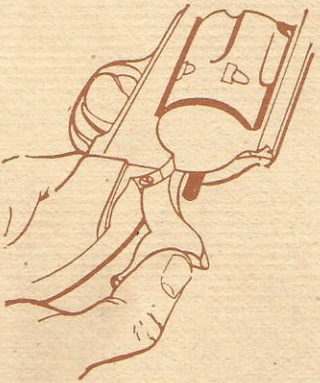
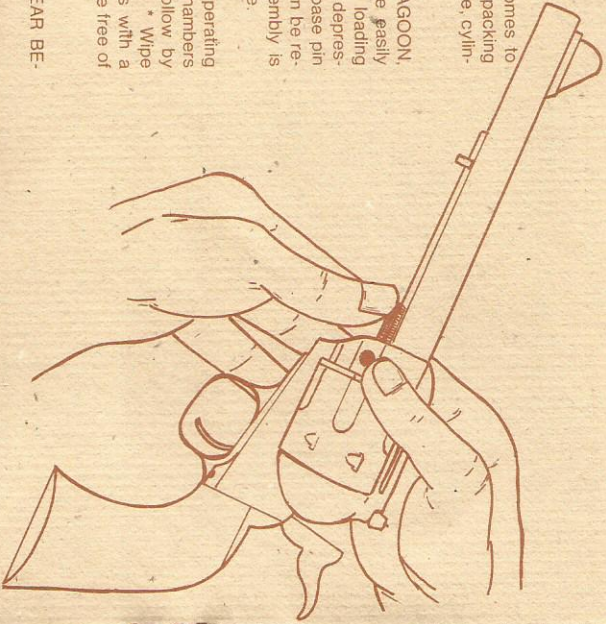

Base Pin Hammer Safety

A modern, patented, hammer safety has been built into the VIRGINIAN DRAGOON as an additional safety to prevent the hammer from striking the firing mechanism from either the half or full-cock positions.

The base pin has two annular grooves which accept the base pin catch. The rear-most groove functions in the standard manner to retain the base pin in its regular operating position. The forward annular groove permits the base pin to function as a hammer safety.

To engage the base pin hammer safety, place the hammer at the half-cock position, then depress the base pin latch and slide the base pin rearward until it engages in the safety position.

To disengage the base pin safety, hold the revolver in the right hand, with the thumb in position to depress the base pin latch (see sketch, page 6). Depress the base pin latch with the right thumb and with the left thumb and forefinger slide the base pin forward until the latch locks in the rear groove.

Hammer Positions

The action of the Interarms, VIRGINIAN DRAGOON is designed to provide three cocking positions for the hammer.

First Position: Pull the hammer back to the first notch. The trigger and hammer are now locked together relieving tension on the floating firing-pin and spring.

Loading Position: Pulling the hammer back to half-cock position permits the cylinder to rotate freely for loading. In this position the base pin safety can be applied.

Firing Position: Pull the hammer back until it engages in the third or firing position. The hammer, in this position, will fall when the trigger is squeezed. The base pin safety may also be applied in this position.

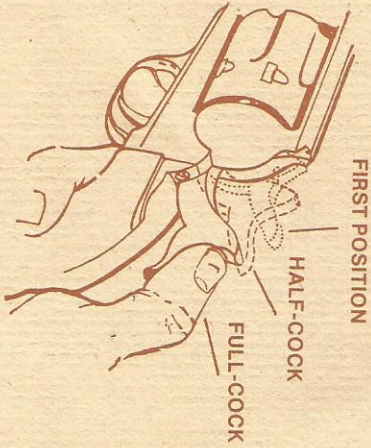

Firing

To fire the VIRGINIAN DRAGOON, disengage the base pin safety while the hammer is at the loading position, then pull the hammer back until it engages in the firing position and squeeze the trigger.

NEVER ATTEMPT TO FIRE THIS GUN WHILE THE BASE PIN LATCH IS DEPRESSED.

Adjustable Sight Model

The basic model of the VIRGINIAN DRAGOON is fitted with fixed field sights. Adjustable target type sights are offered as an option.

The target model features a ramp front sight with horizontal striations to minimize glare and is accented with a white dot for rapid target acquisition and target alignment under poor light conditions. The square notch rear sight is fully adjustable for elevation and windage.

Adjustments are made as follows: To increase elevation (shooting too low), turn top screw clockwise to raise point of impact. To decrease, turn screw counterclockwise. To adjust windage (horizontal placement of shots), turn the screw, located on the right hand side of the rear sight, clockwise to move sight and point of impact to the left. Counterclockwise adjustment will move sight and point of impact to the right.

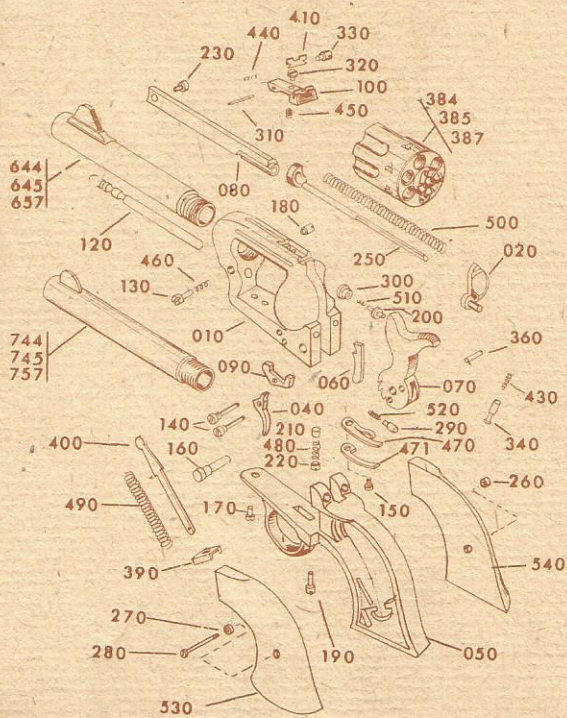

The VIRGINIAN DRAGON

PARTS LIST

Part No.	Description	Part No.	Description
010	Frame	300	Firing Pin Bushing
020	Gate	310	Rear Sight Pivot Pin
040	Trigger	320	Rear Sight Elevation Screw
050	Grip Frame	330	Rear Sight Windage Adjustment Screw
060	Hammer	340	Kicker
070	Hammer	360	Kicker Retaining Pin
080	Ejector Tube	384	Cylinder— .44 Magnum
090	Bolt	385	Cylinder— .45 Colt
100	Rear Sight Block	387	Cylinder— .357 Magnum
120	Base Pin	390	Hammer Spring Retainer
130	Base Pin Screw	400	Hammer Push Rod
140	Trigger & Bolt Pivots	410	Rear Sight Blade
150	Bolt Spring Screw	430	Kicker Spring
160	Hammer Pivot	440	Rear Sight Windage Spring
170	Front Trigger Guard Screw	450	Rear Sight Elevation Spring
180	Base Pin Nut	460	Base Pin Spring
190	Trigger Guard Screws (4)	470	Bolt & Trigger Spring
200	Firing Pin	471	Bolt & Trigger Backer Spring
210	Gate Catch	480	Gate Spring
220	Gate Screw	490	Hammer Spring
230	Ejector Tube Screw	500	Ejector Spring
250	Ejector Rod Assembly	510	Firing Pin Spring
260	Grip Nut	520	Hammer Spring
270	Grip Bushing	530	Left Hand Grip
280	Grip Screw	540	Right Hand Grip
290	Hammer Spring Plunger		
644	Barrel—Field Sights— .44 Magnum		
645	Barrel—Field Sights— .45 Colt		
647	Barrel—Field Sights— .357 Magnum		
744	Barrel—Adjustable Sights— .44 Magnum		
745	Barrel—Adjustable Sights— .45 Colt		
747	Barrel—Adjustable Sights— .357 Magnum		