

INSTRUCTION MANUAL

# CZ 858 Tactical



ČESKÁ ZBROJOVKA  
SINCE 1936

**Before handling the firearm read this manual carefully and observe the following safety instructions.**

Improper and careless handling of the firearm could result in unintentional discharge and could cause injury, death or damage to property. Unauthorized modifications or adjustments, corrosion, or the use of non-standard or damaged ammunition can cause the same consequences. In such cases, the manufacturer shall not be held responsible in any manner whatsoever for the resultant consequences. Before leaving the factory this firearm was tested, carefully inspected, and packed. CZ cannot accept responsibility for product handling while in transit, or upon leaving the factory. Therefore, please examine this firearm carefully at the time of purchase to ensure that it is unloaded and undamaged. This instruction manual should always accompany this firearm, even when loaned, sold or given.

**CONTENTS**

|                                     |    |  |    |
|-------------------------------------|----|--|----|
| SAFETY INSTRUCTIONS                 | 22 | MAINTENANCE INSTRUCTIONS                   | 28 |
| FIREARM DESCRIPTION AND TERMINOLOGY | 24 | Stripping for Cleaning - Disassembly       | 28 |
| OPERATING INSTRUCTIONS              | 25 | Assembling the Rifle                       | 30 |
| Ammunition                          | 25 | Assembled Rifle Inspection                 | 31 |
| Stock Unfolding                     | 25 | Cleaning the Rifle                         | 31 |
| Stock Folding                       | 25 | Cleaning the Barrel Bore and the Cartridge |    |
| Removal of the Magazine             | 25 | Chamber                                    | 32 |
| Magazine Loading                    | 26 | Cleaning of Other Rifle Parts              | 33 |
| Rifle Loading                       | 26 | Preserving                                 | 34 |
| Shooting                            | 26 | Waste Management                           | 34 |
| Reloading During Shooting           | 26 | TROUBLESHOOTING, CAUSES AND REMEDIES       | 35 |
| The Safety and its Operation        | 27 | LIST OF PARTS                              | 37 |
| Unloading the Rifle                 | 27 | TECHNICAL SPECIFICATIONS                   | 38 |
| Sight Adjustment                    | 28 | LIST OF ILLUSTRATIONS                      | 40 |

## SAFETY INSTRUCTIONS

Always follow the safety instructions for your own safety and the safety of others.

1. Always handle your firearm as if it were loaded.
2. Never point your firearm at anything you do not intend to shoot.
3. Never take anyone's word that a firearm is unloaded.
4. Always make sure that your firearm is not loaded before laying it down, or handing it to another person.
5. Always store your firearm unloaded with the striking mechanism released.
6. Never abuse your firearm by using it for any purpose other than shooting.
7. Never leave the firearm cocked and ready to fire unattended.
8. Before loading your firearm ensure that the barrel bore, chamber, and action are clean and clear of obstructions. After shooting, clean a dirtied firearm as soon as possible.
9. Always use only clean, dry, original high quality commercially manufactured ammunition, which is appropriate to the calibre of your firearm.
10. Never drink alcoholic beverages or take drugs before or during shooting.
11. If possible wear both safety glasses and ear protection when shooting.
12. Always keep the safety on when the firearm is loaded and cocked, until you are ready to fire.
13. Always keep clear of, and keep others clear of the ejection port.
14. Never squeeze the trigger or put your finger in the trigger guard until you are aiming at a target and ready to shoot.

15. Always be absolutely sure of your target, and the area behind it, before you squeeze the trigger. A bullet could travel through or past your target up to several hundreds of meters.
16. Never shoot at a hard surface such as rock, or a liquid surface such as water.
17. Never fire your firearm near an animal unless it is trained to accept the noise.
18. Never indulge in "horseplay" while holding your firearm.
19. Failure to fire: always hold the firearm, keeping it pointed towards the target, or a safe open area and wait 30 seconds when the firearm fails to fire. If a hangfire (slow ignition) has occurred, the round will fire within 30 seconds. If the round does not fire, remove the magazine, eject the round and examine the primer; if the firing pin indent on the primer is light, or off centre, or non-existent, have the firearm examined by a competent gunsmith.
20. Always make sure your firearm is not loaded before cleaning, storing or travelling.
21. Always keep and store your firearm and ammunition in separate locked receptacles out of the reach and sight of children and untrained people.
22. Never alter any parts of your firearm as the safety and proper function of your firearm could be seriously compromised.
23. Always be aware that corrosion, use of damaged ammunition, dropping the firearm on hard surfaces or other "coarse treatment" could cause damage you may not see. If something like this happens, have the firearm examined and tested by a competent gunsmith.

## FIREARM DESCRIPTION AND TERMINOLOGY

The names of basic rifle parts used in this Instruction Manual are presented in Fig. 1 on the inner side of the cover. Nomenclatures of all rifle parts are presented in the section *List of Parts*.

The series of CZ 858 TACTICAL cal. 7,62x39 mm semi-automatic rifles belongs to self-loading small arms designed for sport and hunting purposes. These rifles are specifically engineered to comply with Mod. 43 cartridge.

The bolt operation is actuated by ignited powder charge combustion resulting in pressure on the piston from gases generated in the barrel. The portion of gases is tapped off into the gas cylinder, and with the pressure exerted on the piston head drives the breech block carrier rearwards. At the end of the breech block carrier travel the compressed return spring forces the bolt and breech carrier to move forward to its initial position.

The rifles are manufactured in wood stock version under denomination of CZ 858 TACTICAL P Semi-automatic rifle, CZ 858 TACTICAL 2 P Semi-automatic rifle or CZ 858 TACTICAL 4 P Semi-automatic rifle and in the version having folding stock and denominated as CZ 858 TACTICAL V Semi-automatic rifle, CZ 858 TACTICAL 2 V Semi-automatic rifle or CZ 858 TACTICAL 4 V Semi-automatic rifle. The CZ 858 TACTICAL 5 P and CZ 858 TACTICAL 5 V versions are in their design made as repeating rifles (Bolt Action).

The weapon can be fired in single shots from any position be it with the rest or without. The rifle is fed from magazines having capacity 5, 10 or 30 cartridges respectively. When the last cartridge from the magazine is fired, the bolt will remain locked open. Effective fire can be conducted up to distances of 800 meters.

When properly maintained and used, its firing performance and properties remain reliable and safe even under adverse conditions. No tools are needed when stripping/disassembling this automatic rifle for cleaning and preserving.

## OPERATING INSTRUCTIONS

### Ammunition

Use only factory-manufactured standard ammunition of an appropriate caliber, which is in compliance with CIP regulations (International Proof Commission for Firearms), or SAAMI (Sporting Arms and Ammunition Manufacturers' Institute Inc. of the United States). The use of other cartridges could damage the firearm or cause malfunctions or injury to the shooter.

### Stock Unfolding

Grasp from below the automatic rifle handguard with your left hand. Place your right hand thumb on the bolt cover and with the right hand index finger press the folding stock pawl stud up to the stop. Inclining the weapon unfold the stock arm to the right, release the stud and continue the right-hand unfolding till the stock pawl lug audibly snaps in the cut-out of the stock arm front head.

### Stock Folding

Hold the automatic rifle by the left hand at the fore-end from below and place the right hand on the stock arm from the left side. Rest the right hand finger against receiver cover and using index finger press the stud up to stop. Using the right hand continue in folding the stock to the right-hand side of the receiver until the folding stock pawl lug audibly snaps in the cut-out on the front head of the stock arm.

### Removal of the Magazine

Grasp the automatic rifle with the right hand at the pistol grip and using the left hand hold the front wall of the magazine. Place the left hand thumb on the magazine catch and press it forward (Fig. 2). At the same time tilt magazine forwards in the direction of barrel, and take it out from the magazine well in the receiver.

### Magazine Loading

With the open end uppermost, grasp the magazine in one hand. Place a cartridge on the magazine follower with its head towards the rear flat edge of the magazine and press it down until the cartridge is caught under magazine retaining lips (Fig. 3). Place the next cartridge on top of the previous cartridge and slide in the manner as described above.

### Rifle Loading

**ALWAYS MAKE SURE THE RIFLE IS POINTED IN A SAFE DIRECTION WHEN LOADING!**

Grip the rifle with the right hand by its pistol grip and using left hand insert a loaded magazine into magazine well located at the bottom of the receiver. Firstly engage the front lugs, located near the mouth of the magazine, with the recess at the front wall of the magazine well in the receiver. Then tilt the magazine rearwards pushing it home into magazine well until the magazine catch projection audibly engages with the lug located at the rear rim near the mouth of the magazine. Afterward grasp the rifle from below with your left hand by the fore-end and place the other hand on cocking handle of the bolt carrier. Pull cocking handle to the rear up to stop and then release it (Fig. 4). The rifle is now ready to fire. If you do not intend to fire immediately, ensure the firearm safety as described below in the section *The Safety and its Operation*.

### Shooting

Fire can be initiated after shifting the safety lever to its "1" position, i.e. rearwards. After pressing the trigger a single cartridge is discharged. The next cartridge is fired after the trigger is released and pressed again.

### Reloading During Shooting

When the last cartridge has been fired, the bolt stays in its rear (locked open position). Remove the emptied magazine and replace it with a loaded one. Partially retract the bolt, and release it to snap forward. The rifle is loaded again, and ready to fire.

## The Safety and its Operation

Rotate the safety lever perpendicularly downwards. This prevents discharge of the cartridge as the firing pin is blocked and cannot be released. This method of putting the safety lever to Safety-On position does not preclude any standard operation of other parts of the bolt except the striker, so it is possible to load or unload the cartridge from the cartridge chamber.

## Unloading the Rifle

ALWAYS MAKE SURE THE RIFLE IS POINTED IN A SAFE DIRECTION!

In the case that the last cartridge from the magazine has not been fired proceed as follows:

- Shift the safety lever to "Safety-On" position
- Remove the magazine
- Manually retract the bolt up to the stop thus unloading the cartridge from the cartridge chamber
- Shift the safety to position marked "1", i.e. forwards
- Cock the bolt using bolt carrier handle up to the stop
- While keeping the trigger pressed release the bolt to snap forward, this operation disengages firing pin and its spring
- Put the automatic rifle again to "Safety-On" mode

In the case that the last cartridge from the magazine has been fired and the bolt is locked open in its rear position then proceed as follows:

- Remove the magazine
- Shift the safety to position marked "1"
- Cock the bolt using bolt carrier handle up to the stop
- While keeping the trigger pressed release the bolt to snap forward, this operation disengages firing pin and its spring
- Put the automatic rifle again to "Safety-On" mode

### Sight Adjustment

The tangent rear sight can be adjusted after depressing the rear sight locking piece and shifting the slide to desired range determined by the lines 1 up to 8, which denominate range of fire in hundreds of meters (Fig. 5). Besides this the left sight of the rear sight leaf is marked by letter "U" (universal), for shooting at moving targets and night combat at ranges up to 300 meters.

The front sight can be adjusted for elevation and windage by the degree of screwing it into the front sight peg. The front sight rack features in its front face semicircular recess, which exposes middle portion of the front sight pin. The front sight pin and the rack wall recess are provided with two sighting-in lines. When these two lines are just opposite then it indicates the correct windage position of the front sight. The correct front sight position regarding elevation is secured by the drop of nitro-paint applied to the face of the front sight and its rack. Screwing up (screwing down) the front sight, change in the height by 1 thread (0,5 mm) or shifting the front sight pin to the side by 0,5 mm shifts the mean point of impact by 14 cm at 100 meters.

## MAINTENANCE INSTRUCTIONS

### Stripping for Cleaning - Disassembly

1. POINT YOUR RIFLE IN A SAFE DIRECTION!
2. Remove the magazine.
3. Grasp the rifle by the receiver from below and using your right hand thumb depress from the left side the protruding end of receiver cover pin. Then grasp by the right-hand thumb and index finger the knurled head of the pin and pull the pin out to the right until an audible click is heard.
4. Place the right hand thumb against the rear wall of receiver cover. Using the right-hand thumb forward and upward pressure slid the return mechanism out from the receiver (Fig. 6). Grasp the receiver cover and pulling it to the rear remove the whole return mechanism out from the rifle.

5. Using cocking handle retract the bolt to the rear up to stop and then lift it up slightly. Once the front part of the bolt is sufficiently lifted up above the receiver place the right-hand fingers under the bolt gripping the bolt in the palm and take it out from the receiver.
6. Take the bolt into your left hand and grasp the striker-hammer by the head. Rotate the hammer-striker counterclockwise and withdraw to the rear from the breech block carrier (Fig. 7). Projection in the bolt breech carrier must go through cross groove into adjoining concomitant groove at the striker.
7. Retract the breech block to the rear and take it out from carrier in downward direction (Fig. 8).
8. Remove the bolt lock from the breech block by tilting it upwards (Fig. 9).
9. Employing the right-hand thumb press from the left side projecting part of the handguard pin. Then grasp by right-hand thumb and index finger the knurled head of the pin and pull the pin out to the right until an audible click is heard.
10. Using your right-hand remove handguard by lifting up its rear portion and withdrawing it to the rear.
11. Using your left-hand grasp the rifle from below by the fore-end. Grasp the piston with your right hand and press it rearward against the force of piston's return spring. Then tilt the piston upwards away from piston cylinder and pull the piston out by pulling it at an angle forwards sliding it out from the opening at the rear sight base (Fig. 10). If the piston spring has not been shifted out together with the piston, remove it at the direction of the piston's rear end.

**CAUTION:**

No further disassembly is needed for routine maintenance and preserving. Never attempt to disassemble your automatic rifle further. If you assume that your automatic rifle requires adjustment or repair, then entrust this task to a competent gunsmith!

## Assembling the Rifle

1. Using your left-hand grasp the rifle from below by the fore-end. Grasp the piston with the slipped-over spring and insert its cylindrical part downwards up to stop into opening of the rear sight base. Tilt the piston head to the cylindrical seat of the gas cylinder and release the piston. Under the spring pressure the piston will be shifted to its front position.
2. Make the tips of handguard front joiner snap in the grooves on the gas adapter and tilt the handguard down. Insert handguard pin completely to the left thus securing handguard against any inadvertent release.
3. Place the breech lock into seating at the breech block. Put the breech block in recess sited at breech block carrier near the bridge, whereupon shift it forwards to engage the grooves in the carrier. Shift the striker-hammer partially in the breech block carrier so that the witness marks on the striker-hammer and the rear wall of the breech block carrier are oriented opposite to each other (Fig. 11). Then turn the striker-hammer by the full length of the witness mark to the right and insert it into striker-hammer carrier up to stop.
4. Grasp the assembled bolt by the right hand with thumb placed against the rear face of breech block carrier and the middle finger against the front face. Using left hand hold the rifle from below by the receiver with muzzle slightly inclined to the ground. Insert the bolt from above in the rear part of the receiver. Slid the inserted bolt as far as the extreme front position, whereby the striker-hammer remains retained by the left-hand catch of striker (Fig. 12).
5. First of all, insert the striker-hammer spring (operating spring) partially in the cavity of striker and then the return spring in the opening of breech block carrier (Fig. 13). Shift the Safety lever to position "1" and squeeze the trigger. This releases the striker-hammer from the left-hand catch and return mechanism can be moved forwards without any resistance. Pull the front part of the cover under to engage the grooves in the carrier and by pushing forwards and downwards slid the projection of base in the recess in the rear part of the receiver (Fig. 14). Subsequently lock the return mechanism by inserting receiver cover pin until an audible click is heard. If the striker-hammer is not released by squeezing the trigger then it means that the breech block carrier is not in the extreme front position and the striker is held by the right hand catch.

### Assembled Rifle Inspection

When inspecting assembled rifle it is necessary to check

- Function of the bolt
- Function of the trigger unit
- Correctness of the rear sight and front sight
- Function of the shoulder rest

### Cleaning the Rifle

Clean the rifle

- Each time you use it
- If you get your automatic rifle wet
- As soon as possible after shooting
- At least once a year in a temperate climate
- As often as once a month in a tropical climate, or other demanding environments

Cleaning and materials used

- clean fine cloth/swab suitable for cleaning and lubricating of parts and components
- roughly comb hemp oakum without chaff (only for barrel bore cleaning)
- WD 40 preserving oil
- Hairbrush (included in accessories)

### **Cleaning the Barrel Bore and the Cartridge Chamber**

The barrel bore shall be cleaned from the side of the muzzle. For doing this it is necessary to screw both parts of cleaning rod and oakum holder together (Fig. 15). Slid the muzzle cap over cleaning rod. Insert the cleaning rod end with annular groove into longitudinal opening of at the unscrewed oil-can plug and secure it with front sight wrench, which is put through transversal opening in the oil-can plug. Wind a layer of oakum round the oakum holder so that it could pass through the bore with a slight resistance in order that it fills the grooves well. Then immerse the oakum into preserving oil, and oakum holder wrap around with oakum is inserted into the barrel bore from the direction of muzzle. Slid muzzle cap over muzzle thread protection and rotate in such a way that the muzzle thread protection lock is engaged in cut-out of the muzzle cap.

Grasp the cleaning rod by the front sight wrench and plug and push-pull the cleaning rod with its attachment continuously without any undue force seven or ten times through the whole length of the bore. After this remove the muzzle cap, pull the cleaning rod out and replace the oakum; dip it again in the cleaning agent and again draw several times the cleaning rod through the bore. Then clean the cleaning rod of preserving oil and put through the cut in the oakum holder a clean cloth. Repeat cleaning with the cloth a few times if the cloth shows some spots from corrosion, powder residues or fouling. If these spots appear even when the barrel bore has been wiped for several times then it is necessary to repeat cleaning with oakum and preserving oil, and afterwards again using the clean cloth/patches wipe the barrel bore dry. When the last cloth comes out without any traces showing residues of fouling or corrosion then clean the cartridge chamber.

For cartridge chamber and piston cylinder cleaning is the oakum holder screwed into the transverse opening of the oil-can plug from the threadless side of the opening. The cartridge chamber is then cleaned in the same way as the barrel bore, at which the oil-can when in vertical position serves as oakum holder handle.

### Cleaning of Other Rifle Parts

Piston cylinder is wiped with oakum soaked with preserving oil and then wiped dry. Perform cleaning procedure till all firing residues and/or fouling are removed. Piston cylinder wiped dry is then preserved by applying a thin film of preserving oil.

When cleaning the piston, it is necessary to pay attention to removing fouling or other deposits from the circumferential groove on its head. After washing over in cleaning agent the piston shall be wiped with oakum. The piston with fouling and deposits removed shall be wiped dry using a dry cloth and subsequently preserved by applying a light layer of preserving oil.

Receiver, bolt and the non-disassembled trigger unit, rear sight and return mechanism shall be cleaned using wooden sticks with wound-up cloth wetted in preserving oil. Openings, grooves, cut-outs and recesses are cleaned using pointed wood sticks. After cleaning the parts and components shall be wiped dry using a clean cloth and preserving oil. It shall be also checked whether after cleaning of the non-disassembled trigger unit are the positions of trigger unit parts correct, especially trigger unit spring legs.

Parts heavily fouled or dirtied with powder combustion residues could be immersed into preserving oil for 30 minutes at most. Preserving oil remains should be carefully removed.

The wooden parts of the rifle, i.e. the stock, pistol grip and fore-end, shall be wiped with a lightly oil soaked cloth and then wipe dry with clean dry cloth. From time to time apply light impregnation using wood (linseed) oil.

Lacquered parts of the rifle, such as the external surface of the barrel, receiver, trigger guard, receiver cover and buttplate are not preserved but rubbed with grease cloth and then using clean dry cloth wiped.

## Preserving

Preserving material used

- WD 40 preserving oil
- wood or linseed oil to impregnate wooden parts of the firearm

Before beginning of the barrel bore and cartridge chamber preservation pull a cloth soaked with preserving oil through cut-out in the oakum holder. The cloth must be of such a size so as to pass through the bore snugly. Push-pull the cleaning rod with attachment two or three times through the entire length of the bore so that the preserving agent is well adhered to the grooves and lands of the bore and cartridge chamber and forms a thin continuous layer. Excessively greased parts collect dirt very rapidly and for this reason it is necessary to apply only a fine layer of preserving agent using a grease soaked cloth. When lubricating recesses, grooves and slots it is necessary to roll the cloth round a wooden stick.

## Waste Management

When used properly, the materials used in the product and packaging have no adverse effects on human health or the environment. When disposing of the product or its packaging, metal parts (steel and non-ferrous metals), plastics, wood, paper and cardboard should be stored separately in collecting containers intended specifically for that purpose.

**TROUBLESHOOTING, CAUSES AND REMEDIES**

If your automatic rifle is properly used and maintained, malfunctions will rarely occur. However, if such a situation should occur, please observe the following instructions.

**CAUTION** - Should a malfunction occur, the possibility of unintentional discharge is substantially increased. For this reason, carefully observe the *Safety Instructions* already mentioned above. Keep the rifle pointed in a safe direction, do not turn the rifle against your body or anyone else's! Do not place your hands in front of the barrel!

Using "dummy cartridges", practice fast clearing of the malfunctions as described below.

| Malfunction       | Possible Cause   | Remedy   |
|-------------------|--|--|
| Cartridge not fed | <ol style="list-style-type: none"> <li>1. Dirty interior of magazine</li> <li>2. Magazine box walls or mouth deformed</li> <li>3. Magazine follower spring fatigued (weak) or broken</li> <li>4. Bolt short recoil due to dirt or fouling</li> </ol>     | <ol style="list-style-type: none"> <li>1. Disassemble and clean magazine</li> <li>2. Replace the magazine and pass the defective one over to ordnance workshop to be repaired</li> <li>3. Replace magazine follower spring</li> <li>4. Disassemble and clean the rifle</li> </ol>  |
| Misfire           | <ol style="list-style-type: none"> <li>1. Firing pin damaged (if no firing pin indent can be found on the primer)</li> <li>2. Fatigued (weak) or broken striker spring (poor firing pin indent on the primer)</li> <li>3. Defective cartridge</li> </ol> | <ol style="list-style-type: none"> <li>1. Replace firing pin</li> <li>2. Replace striker spring</li> <li>3. After the lapse of about 30 seconds (danger of hangfire/slow ignition) extract and eject the cartridge from the cartridge chamber by manually retracting the bolt. Examine the cartridge whether the primer shows adequate indent caused by firing pin impact, replace the cartridge.</li> </ol> |

|  |  |  |
|--|--|--|
| Piston is not returned to front position                       | Fatigued (weak) or broken piston spring  | Replace piston spring  |
| Failure to lock the bolt                                       | <ol style="list-style-type: none"> <li>1. Dirty bolt</li> <li>2. Defective (deformed) cartridge</li> <li>3. Dirty cartridge chamber</li> </ol>   | <ol style="list-style-type: none"> <li>1. Disassemble the bolt, clean it and apply oil</li> <li>2. Extract and eject the cartridge from cartridge chamber by manually retracting the bolt</li> <li>3. Clean the cartridge chamber</li> </ol> |
| Failure to extract cartridge case from cartridge chamber       | <ol style="list-style-type: none"> <li>1. Extractor spring broken</li> <li>2. Extractor claw broken</li> </ol>                                   | <ol style="list-style-type: none"> <li>1. Replace extractor spring</li> <li>2. Replace extractor</li> </ol>  |
| Failure to eject cartridge case                                | <ol style="list-style-type: none"> <li>1. Short rearward travel (recoil) of the bolt due to dirt or fouling</li> <li>2. Piston broken</li> </ol> | <ol style="list-style-type: none"> <li>1. Disassemble and clean the rifle</li> <li>2. Replace the piston</li> </ol>  |
| Failure to hold cartridges properly (jump-out) in the magazine | Magazine spring too strong or magazine mouth opened too much   | Replace the magazine and pass the defective one over to ordnance workshop  |
| Failure to intercept bolt by the bolt lock                     | <ol style="list-style-type: none"> <li>1. Defective magazine</li> <li>2. Damaged or worn bolt catch</li> </ol>                                   | <ol style="list-style-type: none"> <li>1. Replace the magazine and pass the defective one over to ordnance workshop</li> <li>2. Repair bolt catch by cleaning or replace it</li> </ol>   |

If you cannot clear away any malfunction in the manner described above, entrust the rifle to a competent gunsmith for inspection and repair.

**LIST OF PARTS**

- |                                      |                               |
|--------------------------------------|-------------------------------|
| 1 Barrel                             | 26 Return Spring Guide        |
| 2 Front Sight Support                | 27 Return Spring Cap          |
| 3 Front Sight                        | 28 Trigger                    |
| 4 Muzzle Thread Cover                | 29 Disconnecter               |
| 5 Muzzle Thread Cover Lock w/ Spring | 30 -                          |
| 6 Piston Extension                   | 31 -                          |
| 7 Piston                             | 32 Striker Catch - Left       |
| 8 Piston Spring                      | 33 Trigger Mechanism Retainer |
| 9 Rear Sight Leaf                    | 34 Trigger Unit Spring        |
| 10 Rear Sight Slide                  | 35 Safety                     |
| 11 Receiver                          | 36 Trigger Guard              |
| 12 Ejector                           | 37 Stock                      |
| 13 Breech Block Carrier              | 38 Butt Plate                 |
| 14 Breech Block                      | 39 Butt Plate Screw           |
| 15 Firing Pin                        | 40 Stock Screw                |
| 16 Extractor                         | 41 Handguard                  |
| 17 Extractor Support                 | 42 Fore-end                   |
| 18 Extractor Spring                  | 43 Pistol Grip                |
| 19 Breech Lock                       | 44 Pistol Grip Screw          |
| 20 Striker-Hammer                    | 45 Magazine Shell             |
| 21 Receiver Cover                    | 46 Follower                   |
| 22 Operating Spring Rod              | 47 Follower Spring            |
| 23 Operating Spring                  | 48 Magazine Floorplate        |
| 24 Return Spring Rod                 |                               |
| 25 Return Spring                     |                               |

## TECHNICAL SPECIFICATIONS

| Model   |              | CZ 858 Tactical | CZ 858 Tactical 2 | CZ 858 Tactical 4<br>CZ 858 Tactical 5 |
|---|--------------|-----------------|-------------------|--|
| Calibre   | [mm]         | 7,62x39         | 7,62x39           | 7,62x39                                |
| Overall length of rifle w/ stock                    | [mm]         | 845             | 932               | 845                                    |
| Overall length of rifle w/ stock unfolded           | [mm]         | 845             | 932               | 845                                    |
| Overall length of rifle with folded stock           | [mm]         | 636             | 724               | 636                                    |
| Height of rifle with magazine (long)                | [mm]         | 255             | 255               | 255                                    |
| Overall width of rifle with stock                   | [mm]         | 57              | 57                | 57                                     |
| Overall width of rifle with folded stock            | [mm]         | 72              | 72                | 72                                     |
| Barrel length                                       | [mm]         | 390             | 477               | 390                                    |
| Sight radius  | [mm]         | 353             | 440               | 353                                    |
| Weight of rifle with loaded magazine (short / long) | [kg]         | 3,18 / 3,58     | 3,08 / 3,17       | - / 3,58                               |
| Weight of rifle w/o magazine                        | [kg]         | 2,9             | 2,9               | 2,9                                    |
| Magazine capacity                                   | [cartridges] | 10 / 30         | 5                 | 30                                     |
| Empty magazine weight (short / long)                | [g]          | 120 / 190       | - / 189           | - / 190                                |

|   |           |           |           |           |
|---|-----------|-----------|-----------|-----------|
| Loaded magazine weight (short / long) * | [g]       | 280 / 680 | - / 271   | - / 680   |
| Rate of fire                            | [rpm]     | 40        | 40        | 40        |
| Maximum range of fire                   | [m]       | 2800      | 2800      | 2800      |
| Lethal effect of projectile             | [m]       | do 2800   | do 2800   | do 2800   |
| Rear sight graduation                   | [m]       | 100 - 800 | 100 - 800 | 100 - 800 |
| Rifling                                 |           | 4         | 4         | 4         |
| Rifling Pitch (R.H.)                    | [mm/turn] | 240       | 240       | 240       |
| Muzzle velocity                         | [m/s]     | 705       | 705       | 705       |
| Trigger pull weight                     | [N]       | ~ 37      | ~ 37      | ~ 37      |

\* Depends on ammunition being used

The Company, reserves the right to make any changes it thinks necessary to improve its models or to meet any requirements of manufacturing or commercial nature.

**LIST OF ILLUSTRATIONS**

1. CZ 858 Tactical field-stripped
  - A) Magazine
  - B) Return mechanism
  - C) Bolt
  - D) Handguard
  - E) Piston
2. Removal of the magazine
3. Magazine loading
4. Rifle loading
5. Sight adjustment
6. Sliding return mechanism out
7. Firing pin removal
8. Breech block taken out
9. Breech lock removal
10. Piston withdrawal
11. Striker-hammer insertion
12. Installing bolt into receiver
13. Placing of springs
14. Return mechanism instalment
15. Accessories
  - A) Cleaning rod - upper part
  - B) Cleaning rod - lower part
  - C) Oakum holder
  - D) Hairbrush
  - E) Muzzle cap
  - F) Oil can
  - G) Front sight wrench

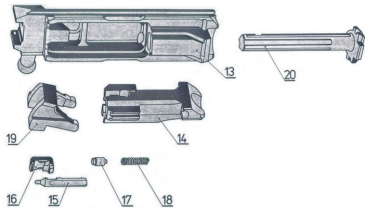
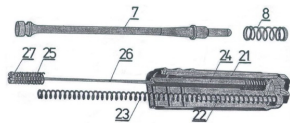





②



③



④

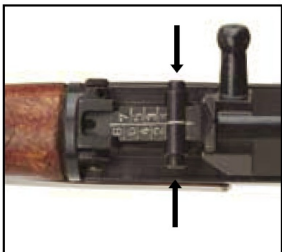

⑤



⑥



ČESKÁ ZBROJOVKA  
SINCE 1936



⑦



⑧



⑨

⑩



⑪



⑫





13

14



15